

**MORE POWER!  
MORE SPEED!  
MORE TORQUE!**

*Viper*  
**'S' SERIES**

**GRAVITY FEED**  
FREE FALL ANCHOR WINCHES  
**USER GUIDE**

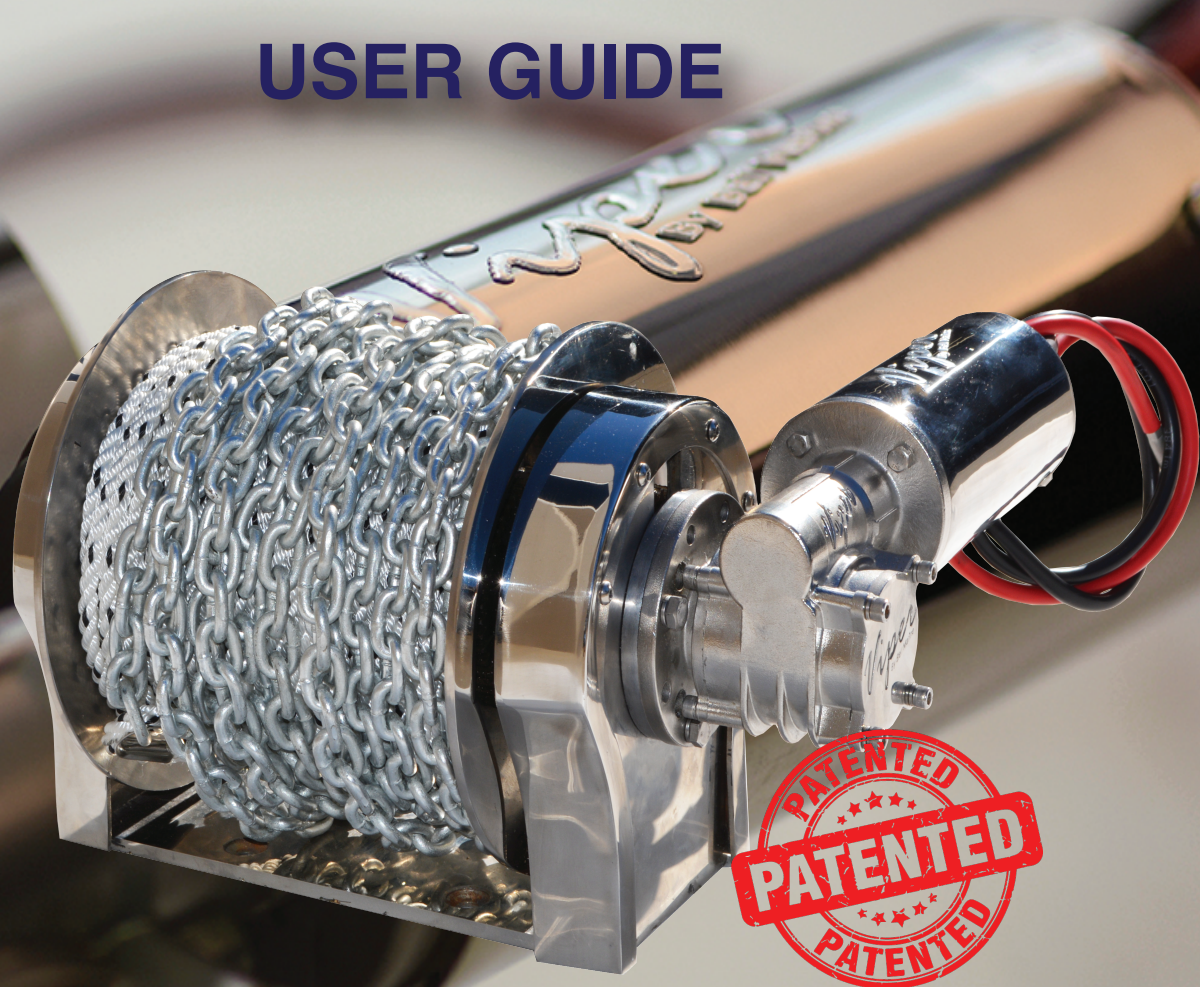

**BELL**  
MARINE  
VIPER PERFORMANCE PRODUCTS

**bellmarine.com.au**

WORLD CLASS STAINLESS STEEL BOATING CHANDLERY & PERFORMANCE BOATING ACCESSORIES

# What's Included In Your Viper Winch Bundle

## Viper S Series "Gravity Feed" Anchor Winch Bundle

Viper Deluxe Anchor Roller (#30009)  
Viper Deluxe Stainless Steel Anchor Swivel (#30001)  
90 meters of Premium Blend Double Braid Anchor Rope  
Pre Spliced to 8mtrs of 6mm Short Link Gal Anchor Chain (#30032) Standard Inclusion Kit  
183 meters H-Spec, rope/chain combo kit (30059) *Optional Upgrade Kit \**  
200 Amp Reversing Solenoid (#30020)  
Illuminated LED Up/Down Elite 2 Gang Switch Panel (#90109)  
100 Amp Flush Mount Circuit Breaker Including Rubber Seal For Wall Mount (#90046)  
5mm Stainless Steel Sandwich Plate  
All Stainless Steel fixings, Bolts, Nuts, Washers, Heat-shrink etc Included  
Viper User Guide, Wiring Diagram  
5 Year Manufacturers Warranty

Please note: If there is any items missing from your winch bundle please contact Bell Marine on (03) 9708 2846 or email us at [support@bellmarine.com.au](mailto:support@bellmarine.com.au) and we will express your items immediately

### 5 Year Limited Warranty

A. This Limited warranty is given by Bell Marine (the company) to the original purchaser (the "purchaser") of a Bell Marine Viper Winch (the "Product") specified in this manual. This 5 Year limited warranty is not transferable to any other party.

B. Responsibilities of the Company under this Limited Warranty

1. Repair or replace (at the discretion of the Company) any part or parts of the Product found by the Company to be defective within a 5 year period from the date of purchase.
2. The Company will pay the transportation charge for shipment back to the Purchaser of any Product received for legitimate Warranty repair.

C: Responsibilities of the purchaser under this warranty.

1. Record your serial number as laser etched on the back of the winch motor, Otherwise, Purchaser will have to show dated proof of purchase to qualify for service under the provisions of the Limited Warranty.
2. Promptly notify the Seller or the Company of any claim hereunder.
3. At the Option of the Company, return the product to the company for inspection. Authorization must be given prior to any product return. Call the Company 61 3 9708 2846 or write the Company at Factory 1, 2 Network Drive Carrum Downs Victoria Australia 3201, for authorization and complete instructions on how to return the product directly to the company.
4. Use reasonable care in installation, maintenance, operation, use and storage of the Product.
5. Have Warranty work, installation performed by a authorized dealer or representative approved by the company if required.
6. Except as noted in B.2., transportation charges to return the unit back to the manufacturer are the responsibility of the Purchaser.
7. Labour costs incurred at any authorised, non authorised service centre, shop, and or place or repair are not covered under the warranty, and are the sole responsibility of the owner/purchaser.

D. This Limited warranty covers:

1. Defects in workmanship or materials.
2. Any part or parts of the product sold or manufactured by the Company, excluding wearable components including but not limited to brushes, and or bearings.

E: This limited warranty does not cover:

1. Any failure that results from improper installation of the Product.
2. Any failure that results from accident, purchaser's abuse, neglect, modification, improper maintenance, or failure to operate and use the product in accordance with Bell Marine.
3. Wearable components including but not limited to brushes, and or bearings, which are considered to be consumable items under normal working conditions.
- 4: Rope and chain kit breakage, damage due to usage, age and or misconduct of boating activity for which the rope/chain was not designed for.
- 5: Labour costs incurred at any authorised, non authorised service centre, shop, and or place of repair are not covered under the warranty, and are the sole responsibility of the owner/purchaser (as listed above in Sub Cat. C)
- 6: Any opening or attempt to open the winch motor and or gearbox will VOID warranty

F. There is no other express warranty. Implied warranties, including those of merchantability and fitness for a particular purpose are limited to one (1) year from date of purchase. This is the exclusive remedy and any liability for any and all incidental or consequential damages or expenses whatsoever is excluded. Some states do not allow limitations on how long an implied warranty lasts, or do not allow exclusion or limitation of incidental or consequential damages, the above limitations may not apply to you. This Limited Warranty gives you specific legal rights and you may also have other rights which vary from state. Bell Marine reserves the right to alter specifications on any product without notice. All rights reserved. This publication or part thereof may not be reproduced in any form without written permission.



# Anchor Winch Wiring Diagram A

RE: 01072016C

## Viper S SERIES GRAVITY FEED DRUM WINCH

**WARNING: Remember never to connect your battery leads until your installation is complete!**

PLEASE NOTE: Pull your wiring loom through your boat first to calculate the position of your winch accessories before cutting any holes.

100 Amp Circuit Breaker

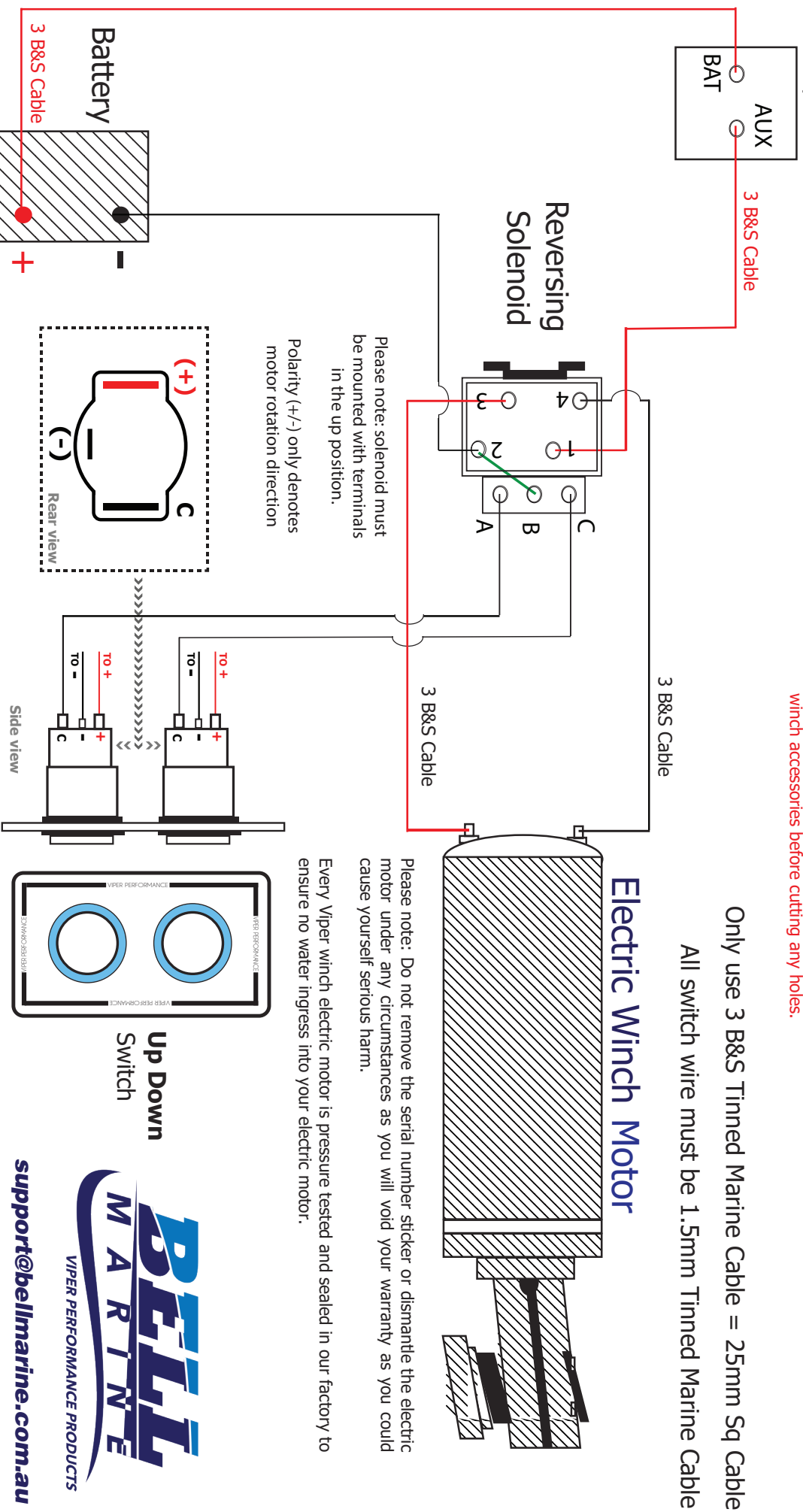

# Typical Winch Installation Samples

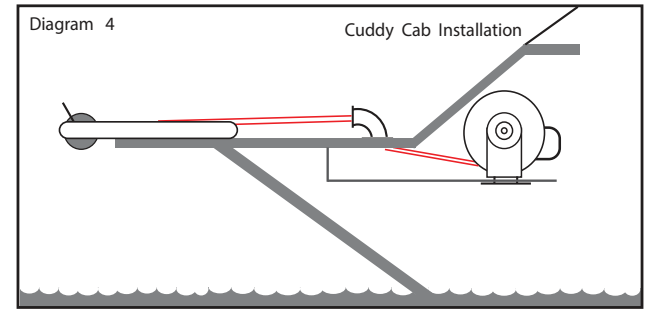
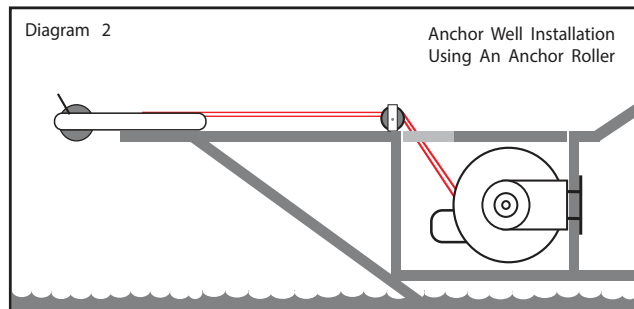
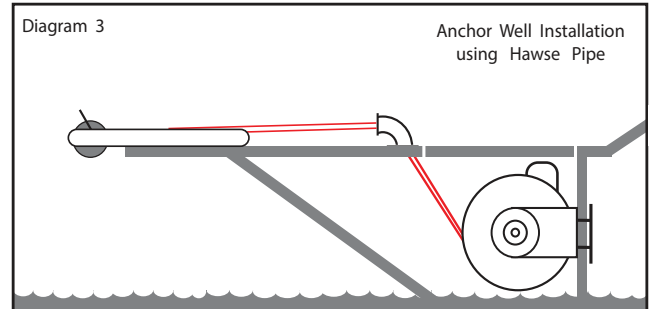
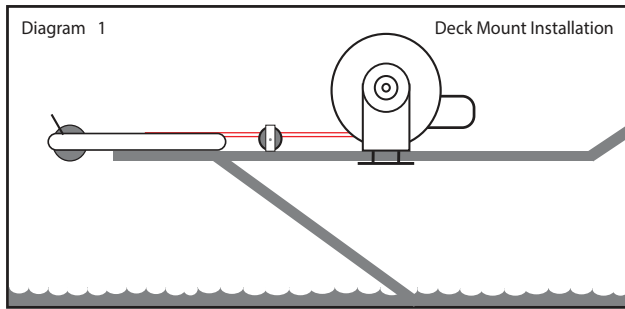

## Installation Note

For the gravity feed winch, rope can only be wound onto the drum in one direction due to its working design - see the list below to help you work out which direction will work for your installation.

These directions are based on your view if you are standing at the steering wheel and facing towards the bow.

### Rope Installation:

Winch Motor is on the Right/Starboard side, feed the rope **over** the drum shaft.

Winch Motor is on the Left/Port side, feed the rope **under** the drum shaft.

# bellmarine.com.au



# OPERATING INSTRUCTIONS

## Viper S Series GRAVITY FEED (free fall) Anchor Drum Winch

### HOW TO ANCHOR USING THE GRAVITY FEED:

- Please make sure your engine is running while operating your winch.
- Engage the circuit breaker to power up your winch.
- Press the down button for 1-2 seconds or until your winch starts to feed rope and release the switch immediately.
- Once your anchor has hit the bottom, if you require more rope, simply reverse your boat back to release more rope.
- Select boats neutral gear, when your drum stops rotating, press the up button for 1-2 seconds to lock your winch into gear

### DO NOT OVER RUN THE ROPE ON THE DRUM:

- Once you are anchored in your desired position, there is no need to tie off the rope.
- Disengage the circuit breaker to cut power from the winch.

### RETRIEVING THE ANCHOR:

- Engage the circuit breaker to power up the winch.
- In ideal weather conditions - Start your engine, simply push the UP switch to retrieve your anchor.
- In rough weather conditions - Start your engine, place your engine in forward gear (moving slowly) releasing the tension of your anchor rope and at the same time pressing your UP switch.
- Continue to push the UP switch until you can see the chain or your chain sock – Then short taps on the switch to bring the anchor up and lock it into your bow roller/sprit.
- Disengage the circuit breaker to cut power to your winch and your right to go. (optional)

### SAFETY SWITCH:

The Viper Pro Series Winch has a safety switch (circuit breaker) located on the switch panel or under your dash. When traveling or anchored disengage the red lever on the circuit breaker to cut power to your winch. This will prevent accidental use while anchored or traveling.

### MAINTENANCE:

No specific maintenance is required however, a quick hose down with fresh water when washing your boat is optional, a quick check of your rope and anchor chain before each trip is recommended. Also soaking your anchor rope in a bucket of warm water and fabric softener annually will keep your anchor rope soft and subtle ensuring it lays on nice and evenly.

### ELECTRICAL FAILURE:

It is advised that a spare anchor, rope and chain is available on the boat so the anchor can be deployed for safety reasons, if your electrics fail or you flatten your battery/s.

## Troubleshooting Guide

**Warning!**  
Please ensure hands, feet, hair and clothing are kept well away from the drum winch whilst in use.

#### **- If there is a build up on one side of the drum:**

The winch has been installed off-center. This means the center of the drum has not been lined up on the center lines between the bow sprit and the center of the anchor well or the winch installation is not square to the bow sprit.

#### **- If the rope and/or chain jams on the baseplate:**

If you have installed a non factory rope/chain kit, then you may have too much rope. You will need to remove rope from the drum to rectify this problem.  
If you have a Viper rope & chain kit, then you may be causing this problem by driving too far forward when retrieving your anchor, and creating a loose line effect, hence this can cause the rope/chain in the middle of your drum  
*If your anchor fails to fall:*

When the down switch is pressed, check that there is a natural force of gravity when the anchor is up and located in the bow sprit. If this is not the case you may look at a replacement bow roller/sprit or lower your front roller.

#### **- If you over-run the rope and the rope spills over the side of the drum**

Have a second person apply tension on the rope whilst you inch the winch in opposite direction. Continue this until all of the rope is spooled back onto the drum. (ensure to keep your fingers and body parts far enough away from any moving parts)

- If the operation of the winch slows down check that the batteries are charged or connect to a second battery. If your boat is fitted with dual batteries, have the battery switch on BOTH.

- If the drum spools only in one direction check the connections to the solenoid, motor, circuit breaker and battery.

- If your winch fails to operate check that the circuit breaker is switched on.

- If the actuator fails, check the 100amp circuit breaker to make sure it has not tripped.



# Anchor Winch Options

## Viper "S" SERIES ALLOY BOAT FITMENT KIT "Recommended for all aluminum boats"

As the production of alloy boats increases, more and more winches are being fitted to aluminum runabouts and Pro Series boats. The two (2) biggest problems with fitting a full stainless steel winch or any stainless fitting to an aluminum boat is the reaction between the 2 different metals in a salt water environment.

The second issue is, if there is a 12V power supply to the equipment you are fitting and unless you are 100% sure you have insulated all stainless steel from your aluminum hull, deck or dash, electrolysis will eat everything away.

The Alloy fitment kit includes 2 HD plastic winch sandwich plates, anchor roller insulation, insulation spacers for each bolt, aluminum switch face plate. **RECOMMENDED FOR EVERY ALLOY BOAT!**



**NEW RELEASE!**

- P/N 30038-A ALLOY FITMENT KIT FOR VIPER S SERIES MICRO WINCH
- P/N 30021-A ALLOY FITMENT KIT FOR VIPER S SERIES RAPID WINCH
- P/N 30072-A ALLOY FITMENT KIT FOR VIPER S SERIES GRAVITY FEED
- P/N 30003-A ALLOY FITMENT KIT FOR VIPER S SERIES 1500 WINCH

## Viper PRO SERIES MARINE GRADE WIRING LOOMS FOR MICRO/RAPID/GRAVITY FEED & 1500 WINCHES



P/N 30034 MARINE WIRING LOOM FOR BOATS UP TO 6 MTR (MICRO/1000)

P/N 30035 MARINE WIRING LOOM FOR BOATS UP TO 8 MTRS (MICRO/1000)

P/N 30060 MARINE WIRING LOOM FOR BOATS 9MTRS & UNDER- (SERIES 1500)

P/N 30061 CUSTOM MADE WIRING LOOM

## PRO SERIES DELUXE STAINLESS STEEL BOW ROLLERS

W100 X L500 X H 250MM  
(MOUNT AREA 300 X 100MM)



P/N 30016  
VIPER PRO SERIES  
DELUXE BOW ROLLER SMALL



P/N 30006  
VIPER PRO SERIES DELUXE  
SINGLE ROLLER BOW ROLLER

P/N 30007 VIPER PRO SERIES DELUXE BOW ROLLER LARGE  
W70 X L370 X H210MM (MOUNT AREA 210 X 70MM)

## ORIGINAL AND THE BEST CHAIN SOCKS - AUST MADE

ALSO AVAILABLE  
IN FLUO GREEN



- P/N 30053 VIPER CHAIN SOCK TO SUIT 6MM SHORT LINK CHAIN-8MTRS
- P/N 30053G VIPER CHAIN SOCK TO SUIT 6MM SHORT LINK CHAIN-8MTRS
- P/N 30036 VIPER CHAIN SOCK TO SUIT 6MM SHORT LINK CHAIN-10MTRS
- P/N 30036G VIPER CHAIN SOCK TO SUIT 6MM SHORT LINK CHAIN-10MTRS
- P/N 30037 VIPER CHAIN SOCK TO SUIT 8MM SHORT LINK CHAIN-12MTRS

## GALVANIZED & POLISHED STAINLESS STEEL ANCHORS

Designed by Bell Marine to suit most bow rollers and a must for electric winch installations, these ploughs are guaranteed to hold bottom in any weather conditions and will not damage your bow roller on retrieval which prevents your rope from damage. You will never need to go up to the bow of your boat ever again and kick your anchor off, these plough anchors self-launching, each and every-time and now come with stainless steel D shackle with counter sunk allen key S/S bolt.



- P/N 30015 10LB/5KG GALVANISED PLOUGH ANCHOR
- P/N 30011 15LB/7KG GALVANISED PLOUGH ANCHOR
- P/N 30012 20LB/9KG GALVANISED PLOUGH ANCHOR
- P/N 30028 25LB/12KG GALVANISED PLOUGH ANCHOR
- P/N 30029 35LB/16KG GALVANISED PLOUGH ANCHOR



- P/N 30013 5kg S/S PLOUGH ANCHOR
- P/N 30014 7kg S/S PLOUGH ANCHOR
- P/N 30030 9kg S/S PLOUGH ANCHOR

## Viper PRO SERIES DELUXE ANCHOR SWIVELS

Bell Marine deluxe anchor swivels are normally attached between your chain and anchor, reducing the chance of your rope and chain getting twisted and your anchor spinning on the way up and damaging your hull. The 316 stainless steel joint allows for perfect transition through your anchor rollers with no risk of damage to any components on your boat - rated to 200kgs/440lbs

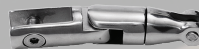

P/N 30001  
VIPER PRO SERIES DELUXE ANCHOR  
SWIVEL SMALL SUIT 6 - 8MM CHAIN

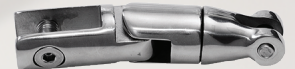

P/N 30019  
VIPER PRO SERIES DELUXE ANCHOR SWIVEL  
LARGE SUIT 8-12MM CHAIN

## NEW VERSION! Viper PRO SERIES HAWSE PIPES

30023 - VIPER PRO SERIES HAWSE PIPE SMALL  
Opening W90 x 55mm  
Flange W158 X D97mm  
Cut Out W120 X 65mm  
Overall Height 78mm



30031 VIPER PRO SERIES HAWSE PIPE LARGE  
Opening W195 X H100mm  
Flange W220 X D120mm  
Cut Out W190 X 85mm  
Overall Height 130mm